

Map 9

Map 32

Map 33

Map 11

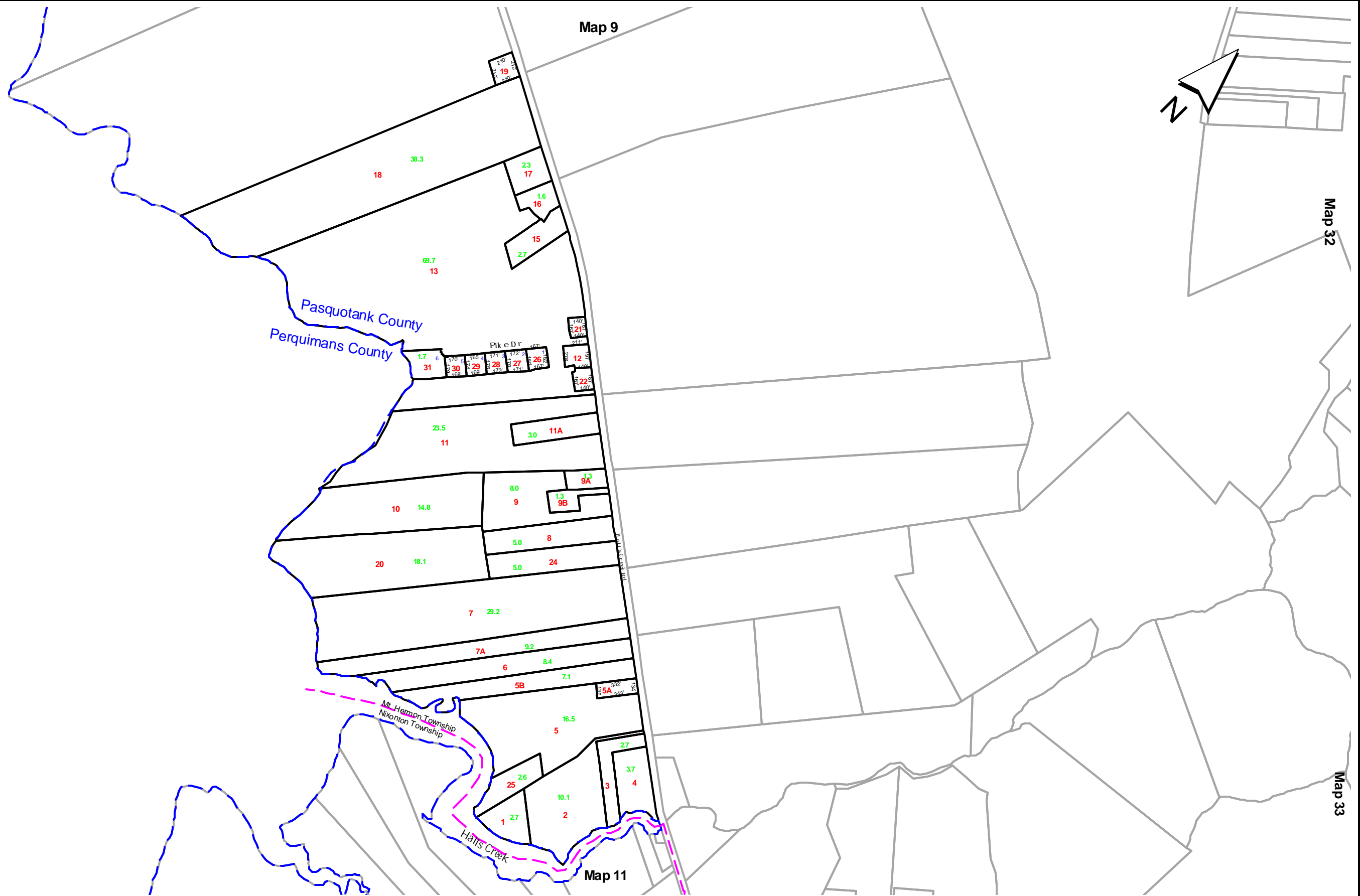

Drawn by
 Pasquotank County GIS Department
 PO Box 193
 Elizabeth City, North Carolina 27907

- County Line
- City Limits
- - - Township Line
- Property Line
- 123A Tax Parcel Number
- 45 Lot Number
- 67.8 Calculated acreage (Calculated by GIS)

This map was compiled from aerial survey, deed descriptions, ground check and GIS information to be used for tax purposes only. The county assumes no responsibility for the legal accuracy of information contained herein.

Pasquotank County
 North Carolina
 Scale : 1" = 800'
 Current as of June 1, 2002

P10
 Map Number